

Via Vincenzo Bellini

B

Tot camera	19,45V
Ingr. soggiorno	26,06V
camera	12,87V
ripost	2,19V
disimp	2,25V
disimp	4,04V
bagno	4,57V
cucina	9,05V
<hr/>	
	80,48

balcone 5,27
Verande 7,05

A

A

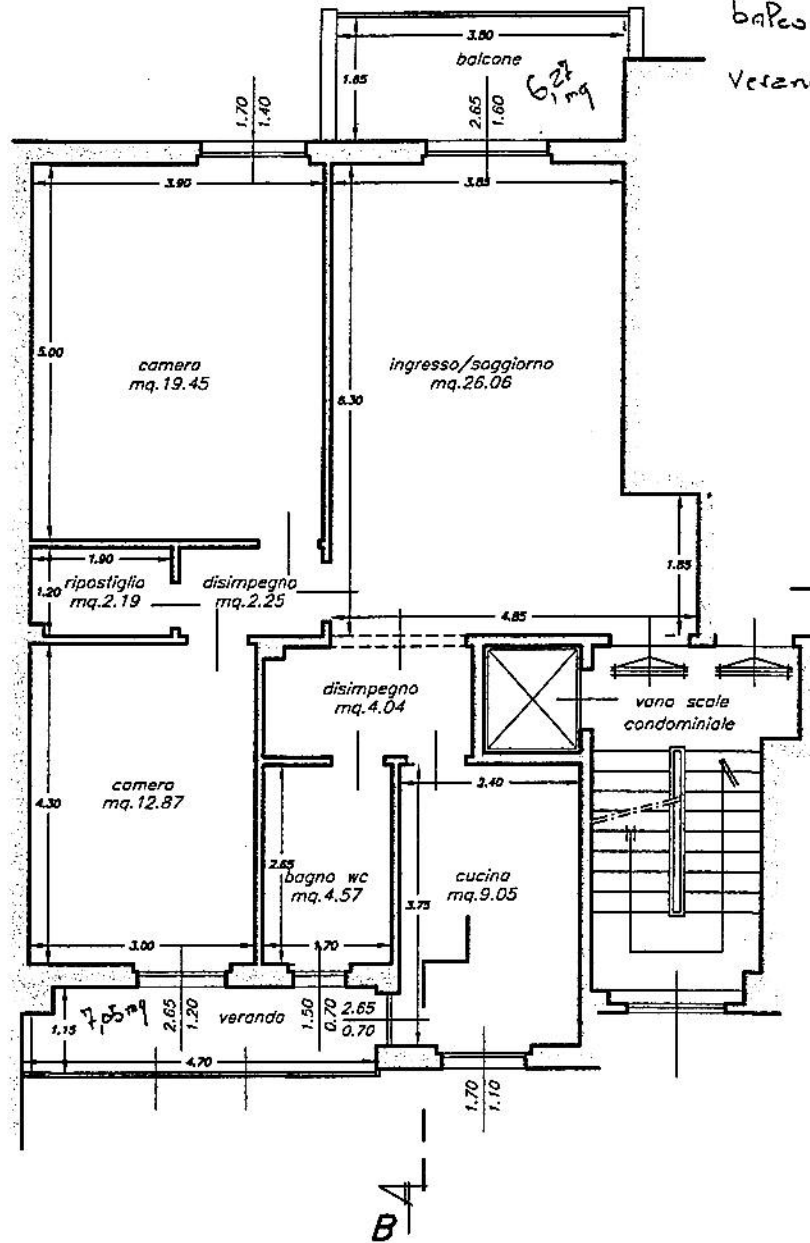

PIANTA PIANO SECONDO